

StudcoBuildIT

Engineering & Design Made Easy
For Architects, Engineers & Builders

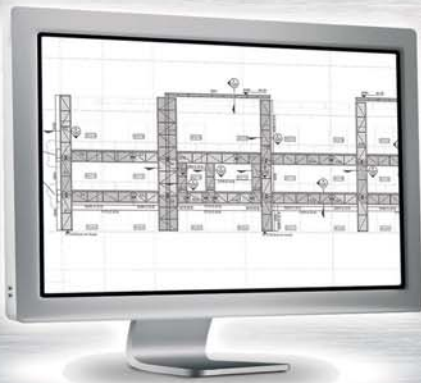

Got any questions about engineering...?



Find out the facts and get peace of
mind from Studco Technical Services.

SOLUTIONS

- Ease of construction
- Best value solution
- Simple designs
- Certified engineers
- Simple solutions

SYSTEMS

- Internal & external walls
- Ceiling systems
- Structural stud systems
- Top hat systems
- Sound-rated acoustics
- Energy-efficient designs

SERVICES

- Technical advice
- Engineering documents
- Computations
- Engineer's opinions
- Detail drawings
- On-site support

The Contractor's Choice For Engineering ...

Studco Building Systems US LLC
1700 Boulter Industrial Parkway
Webster 14580 New York USA

Phone: int+ 1 800.675.8023
Fax: int+ 1 585.545.3010
Email: sales@studcosystems.com

www.studcosystems.com

STUDCO
BUILDING SYSTEMS



StudcoBuildIT

Engineering & Design Made Easy
For Architects, Engineers & Builders

The modern day steel stud market has moved from offering steel in Gauges which offers a broad range of thickness tolerances to a range of hybrid varieties under term "EQ" standing for Equivalent. This has resulted in misunderstandings in relation to what the Architect and contractor alike are expecting as far as the thickness is concerned.

As a result Studco Building Systems has moved forward with a decimal system to simplify the industry so that the market understands what they are actually receiving.

As a result Studco has released the CrocStud™ steel framing system based on the new "IMPERIAL DECIMAL SYSTEM".

The CrocStud™ Imperial Decimal System is made up of Drywall and Structural steel framing.



As can be seen in the table (left), there is a smaller tolerance between Design and Minimum Thickness. Previously Gauge offered a broad spectrum of thicknesses with the true definition on 20 Gauge being .0359" and 25 Gauge being .0209". The stud industry came up with its own variation and named it 'EQ'. As a result a 20 Gauge Equivalent 'EQ' thickness in Mils is anywhere from .018 to .024 depending on the manufacturer.

CrocStud Drywall Steel Stud Framing

Name	Mils	Design Thickness	Minimum Thickness
CrocSTUD25L	16	0.0161	0.0155
CrocSTUD25	18	0.0188	0.0179
CrocSTUD20L	20	0.0205	0.0198
CrocSTUD20	23	0.0245	0.0231
CrocSTUD30	30	0.0312	0.0296

Structural Steel Stud Framing

Former Gauge	Name	Mils	Design Thickness	Minimum Thickness
20	33 Mils	33	0.0346	0.0329
18	43 Mils	43	0.0451	0.0428
16	54 Mils	54	0.0566	0.0538
14	68 Mils	68	0.0713	0.0677
12	97 Mils	97	0.1017	0.0966



Studco CrocStud™ and CrocTrack Drywall Framing products are made with Prime Galvanized steel of the highest quality material, bringing you the strength and confidence that you need to complete any project, and meet or exceed all applicable ASTM (American Society for Testing and Materials) standards.

Studco Building Systems US LLC
1700 Boulter Industrial Parkway
Webster 14580 New York USA

Phone: int+ 1 800.675.8023
Fax: int+ 1 585.545.3010
Email: sales@studcosystems.com

www.studcosystems.com

